

KEY TO MAP

500-Year Flood Boundary		ZONE B
100-Year Flood Boundary		ZONE A1 DATE
Zone Designations* With Date of Identification e.g., 12/2/74		ZONE A5 DATE
100-Year Flood Boundary		ZONE B
500-Year Flood Boundary		ZONE B
Base Flood Elevation Line With Elevation In Feet**		513
Base Flood Elevation In Feet Where Uniform Within Zone**		(EL 987)
Elevation Reference Mark		RM7
River Mile		M1.5

\*\*Referenced to the National Geodetic Vertical Datum of 1929

\*EXPLANATION OF ZONE DESIGNATIONS

ZONE	EXPLANATION
A	Areas of 100-year flood; base flood elevations and flood hazard factors not determined.
A0	Areas of 100-year shallow flooding where depths are between one (1) and three (3) feet; average depths of inundation are shown, but no flood hazard factors are determined.
AH	Areas of 100-year shallow flooding where depths are between one (1) and three (3) feet; base flood elevations are shown, but no flood hazard factors are determined.
A1-A30	Areas of 100-year flood; base flood elevations and flood hazard factors determined.
A99	Areas of 100-year flood to be protected by flood protection system under construction; base flood elevations and flood hazard factors not determined.
B	Areas between limits of the 100-year flood and 500-year flood; or certain areas subject to 100-year flooding with average depths less than one (1) foot or where the contributing drainage area is less than one square mile; or areas protected by levees from the base flood. (Medium shading)
C	Areas of minimal flooding. (No shading)
D	Areas of undetermined, but possible, flood hazards.
V	Areas of 100-year coastal flood with velocity (wave action); base flood elevations and flood hazard factors not determined.
V1-V30	Areas of 100-year coastal flood with velocity (wave action); base flood elevations and flood hazard factors determined.

NOTES TO USER

Certain areas not in the special flood hazard areas (zones A and V) may be protected by flood control structures.  
 This map is for flood insurance purposes only; it does not necessarily show all areas subject to flooding in the community or all planimetric features outside special flood hazard areas.  
 For adjoining map panels, see separately printed Index To Map Panels.

INITIAL IDENTIFICATION  
 SEPTEMBER 18, 1970

Interim map revision effective July 1, 1974 to change zone designations.  
 Map revised June 15, 1978 to reflect curvilinear flood boundary and to include special flood hazard areas in northern areas of county.

To determine if flood insurance is available in this community, contact your insurance agent, or call the National Flood Insurance Program, at (800) 638-6620, or (800) 424-8872.

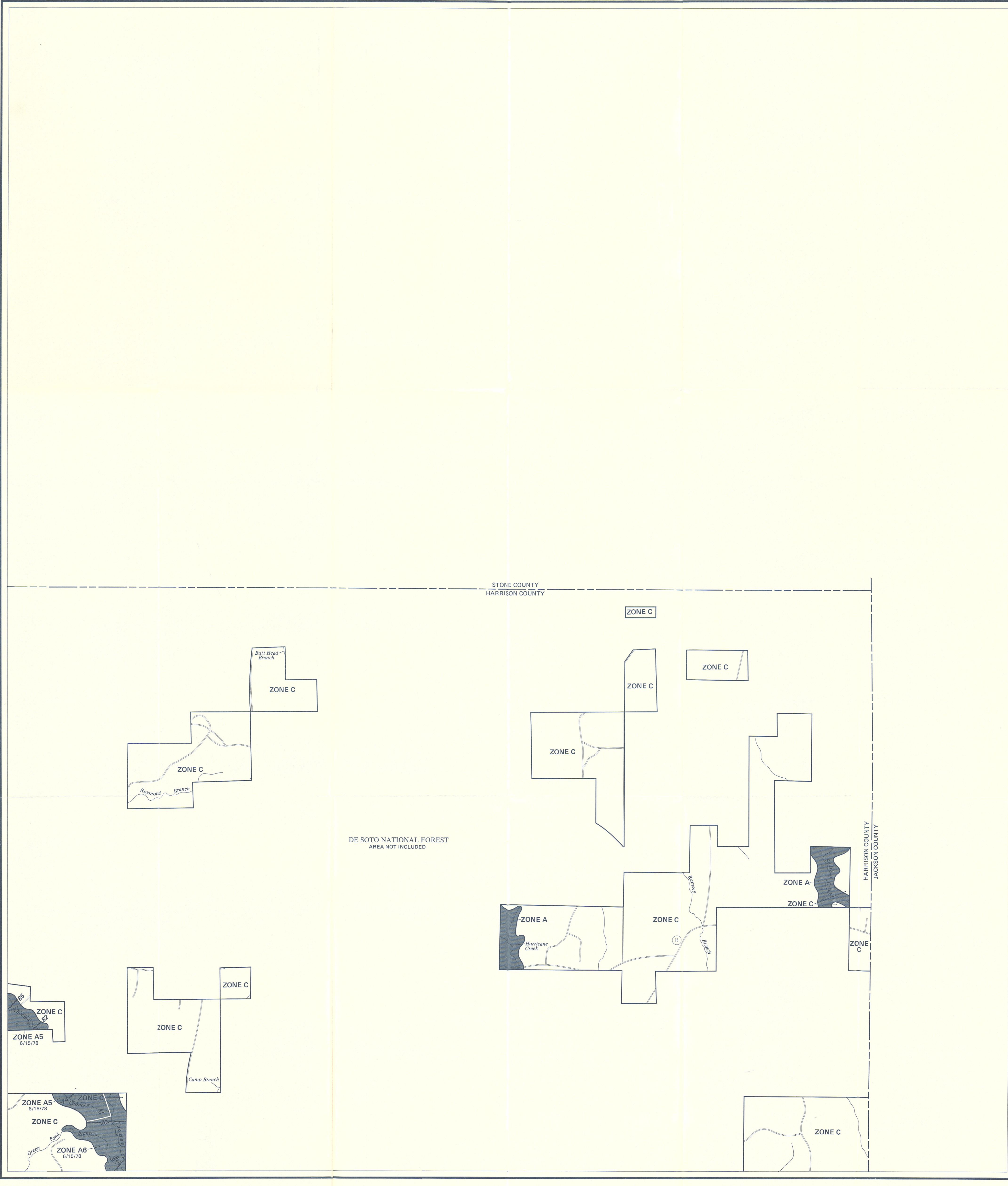
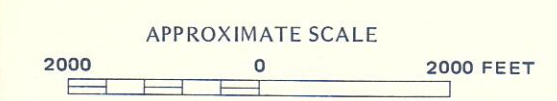

NATIONAL FLOOD INSURANCE PROGRAM

FLOOD INSURANCE RATE MAP

**HARRISON COUNTY,  
 MISSISSIPPI  
 (UNINCORPORATED AREAS)**

COMMUNITY-PANEL NUMBER  
**285255 0075 A**

**PAGE 75 OF 375**  
 (SEE MAP INDEX FOR PAGES NOT PRINTED)

MAP REVISED  
 JUNE 15, 1978



U.S. DEPARTMENT OF HOUSING  
 AND URBAN DEVELOPMENT  
 FEDERAL INSURANCE ADMINISTRATION